

KRISTAL



LEGENDS
A Name That Lights The Nation



IATF 16949:2016 CERTIFIED

OEM Standard Auto Components

KK LIGHTING INDIA PVT. LTD.



KK Lighting India Pvt. Ltd. was established in 1970 and has been designing and manufacturing vehicle lighting. With 50 Years of experience KK Lighting India Pvt.Ltd. developed and utilized its extensive lighting expertise and advanced designs to bring our customer a wide range of high quality products

A manufacturing company of automotive head lamp, rear combination lamp, front combination lamp, indicator, Reflex reflector, Work Lamp, LED rear combination lamp, & indicator, LED work Lamp, Projector Lamp & Plastic Moulded Componentsetc



OUR QUALITY

K K Lighting is committed to provide Customer Satisfaction through delivery of quality products with reliability, economy & innovation by technologically advanced approach.

To build trust and ensure the growth of employees & service partners through fair business practices.

To ensure safety of employees & environment by implementing hazard based approach and environment friendly practices.

To ensure meeting all the regulatory & legislative requirements related to Occupation, Health & Safety of employees and Environment.

KK LIGHTING INDIA PVT. LTD.

Growth Story



We have an inspiring long journey. Our innovative solution and customized services have shown us the way to growth and prosperity. We command a formidable presence both in after markets and OEMs and have achieved a high level of client appreciation by understanding their requirements and exceeding their expectation.

What we are now is because of what we have been doing for past 4 decades.

1970: Commenced as a company manufacturing holder the name of **Gurucharan International** under the brand name **KK**

1975: The company diversified from manufacturing holder to lighting and sheet metal parts.

1985: Entered into the plastic moulded industry and Started dealing with commercial vehicles.

1995: Widened the horizon by venturing into private vehicles and becoming a reliable name among the after market customer.

1999: Established advance manufacturing unit and a corporate office in Narela with all the requisite infrastructure and technology.

2004: Commenced export to more than 10 countries.

2008: Started another firm **Lighto Plast Industry** with the brand name **Krisstal**.

2011: Expended business with manufacturing for OEMs like **Standard Tractor, Rasandik Industries India Ltd. Preet Tractor and Combine. Apollo Construction Pvt. Ltd., ACE Construction Ltd.**

2012: Started another company **Gurucharan Exports Pvt. Ltd.**

2014: Entered in automotive OEMs with AMW Globle Trucks.

2016: Stared hard coating in PC Lens.

2017: Established **KK LIGHTING INDIA PVT. LTD.** modern manufacturing unit in kundli (Sonipat) with all advance machines and equipments as per OEMs requirement.

KK LIGHTING INDIA PVT. LTD.

WE ARE THE LEADING MANUFACTURERS OF AUTOMOTIVE LAMPS & SIGNALING LAMPS

OUR VALUABLE CUSTOMERS



OUR CERTIFICATION & TESTING AGENCY



KK LIGHTING INDIA PVT. LTD.

E VEHICLE LED PRODUCTS



PART NO.- KR-9344



PART NO.- KR- 9345



PART NO.- KR- 9347



PART NO.- KR-9346



PART NO.- KR- 9358



PART NO.- KR- 9359



PART NO.- KR- 9349



PART NO.- KR- 9348



PART NO.- KR- 9360



PART NO.- KR- 9361



PART NO.- KR- 9362



PART NO.- KK- 51011



PART NO.- KK- 51012



PART NO.- KK-51013



PART NO.- KK- 51014



PART NO.- KK-51015



PART NO.- KR- 9352



PART NO.- KR-9353



PART NO.- KR-9354



PART NO.- KR- 9365

NEXT PAGE

KK LIGHTING INDIA PVT. LTD.

E VEHICLE LED PRODUCTS



PART NO.- KK- 9335



PART NO.- KK- 9336



PART NO.- KK- 9337



PART NO.- KK- 9324



PART NO.- KK- 9325



PART NO.- KK - 9331



PART NO.- KR-9254



PART NO.- KR-9255



PART NO.- KR- 9258

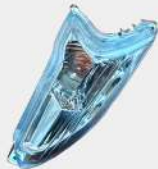

PART NO.- KR- 9257



PART NO.- KR- 9256



PART NO.- KR- 9261



PART NO.- KR- 9287



PART NO.- KR- 9288



PART NO.- KR- 9289



PART NO.- KR- 9290



PART NO.- KR- 9291



PART NO.- KR- 9308



PART NO.- KR- 9307



PART NO.- KR- 9262

NEXT PAGE

E VEHICLE LED PRODUCTS



PART NO.- KR- 9259



PART NO.- KR- 9260



PART NO.- KK-9334



PART NO.- KK-9333



PART NO.- KK-51016



PART NO.- KK- 51017



PART NO.- KK- 51018



PART NO.- KK- 51019



PART NO.- KK- 51020



PART NO.- KK- 51021



PART NO.- KK- 51022



PART NO.- KR- 51023



PART NO.- KK- 51024



PART NO.- KK- 51025



PART NO.- KK- 51026



PART NO.- KK- 51027



PART NO.- KK- 732AA



PART NO.- KR- 9252



PART NO.- KK- 9173



PART NO.- KK- 9236

NEXT PAGE

KK LIGHTING INDIA PVT. LTD.

E VEHICLE LED PRODUCTS



PART NO.- KK- 51049



PART NO.- KK- 51050



PART NO.- KK- 51051



PART NO.- KK- 51052



PART NO.- KK- 51053



PART NO.- KK- 1705



PART NO.- KK- 51054



PART NO.- KK- 51055



PART NO.- KK- 51056



PART NO.- KK- 51057



PART NO.- KK- 51058



PART NO.- KR- 9364



PART NO.- KK-51029



PART NO.- KK-51030



PART NO.- KK-51031



PART NO.- KK-51032



PART NO.- KK-51033



PART NO.- KK- 51034



PART NO.- KK- 51035



PART NO.- KK-51036

NEXT PAGE

KK LIGHTING INDIA PVT. LTD.

E VEHICLE LED PRODUCTS



PART NO.- KK- 51037



PART NO.- KK- 51038



PART NO.- KK- 51039



PART NO.- KK- 51040



PART NO.- KK- 51041



PART NO.- KK- 1703



PART NO.- KR- 9318A



PART NO.- KK- 51044



PART NO.- KK- 51045



PART NO.- KK- 51046



PART NO.- KK- 51047



PART NO.- KK- 51048



PART NO.- KK- 921A



PART NO.- KK- 922A



PART NO.- KK- 921H



PART NO.- KR- 31001



PART NO.- KR-31002



PART NO.- KR-31003



PART NO.- KR-31004



PART NO.- KR-31005

NEXT PAGE

KK LIGHTING INDIA PVT. LTD.

E VEHICLE LED PRODUCTS



PART NO.- KK- 9268



PART NO.- KK- 9285



PART NO.- KK- 9285D



PART NO.- KR- 9237



PART NO.- KK- 9189



PART NO.- KK- 9176A

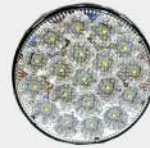

PART NO.- KK- 9176



PART NO.- KK- 9295



PART NO.- KK- 9177



PART NO.- KK- 9178



PART NO.- KK- 9183A



PART NO.- KK- 9119



PART NO.- KK- 9316



PART NO.- KK- 9112



PART NO.- KK- 1051AA



PART NO.- KK- 9275D



PART NO.- KK- 9108



PART NO.- KK- 51028



PART NO.- KK- 064



PART NO.- KK- 9179

NEXT PAGE

KK LIGHTING INDIA PVT. LTD.

E VEHICLE PLASTIC PRODUCTS



PART NO.- KR-9367-001



PART NO.- KR-9367-003



PART NO.- KR-9367-004



PART NO.- KR-9367-005



PART NO.- KR-9367-006



PART NO.- KR-9367-007/8



PART NO.- KR-9367-002



PART NO.- KR-9367-009



PART NO.- KR-9367-010



PART NO.- KR-9367-011



PART NO.- KR-9367-012



PART NO.- KR-9367-013



PART NO.- KR-9367-017



PART NO.- KR-9367-014



PART NO.- KR-9367-015



PART NO.- KR-9367-016



PART NO.- KR-9367-018



PART NO.- KR-9367-019



PART NO.- KR-9367-020



PART NO.- KR-9367-033

NEXT PAGE

E VEHICLE PLASTIC PRODUCTS



PART NO.- KR-9367-021



PART NO.- KR-9367-022



PART NO.- KR-9367-023



PART NO.- KR-9367-024



PART NO.- KR-9367-025



PART NO.- KR-9367-026



PART NO.- KR-9367-027



PART NO.- KR-9367-028



PART NO.- KR-9367-029



PART NO.- KR-9367-030



PART NO.- KR-9367-031

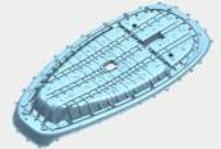

PART NO.- KR-9367-032

Coming soon....

Coming soon....

Coming soon....

Coming soon....

Coming soon....

Coming soon....

Coming soon....

Coming soon....

NEXT PAGE

OUR TESTING DESIGN

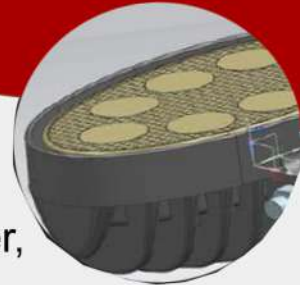
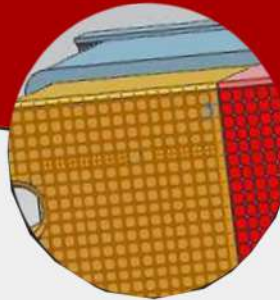
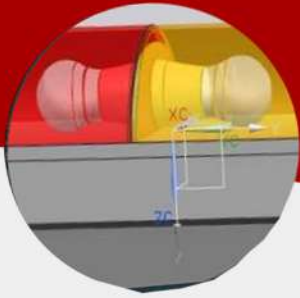

We specialized in product development according to the customer, we can make the product by designing the client's given concept.

DESING / CAD CAM

1. Auto cad
2. Unigraphics
3. Solidworks

TOOL DESIGN

1. Mould/Die/Automotive Lamp Design
2. Feeler 3 Axis CNC Milling Machine
3. Jigs & Fixture Design

NEXT PAGE

KK LIGHTING INDIA PVT. LTD.

PLANT INFRASTRUCTURE ASSEMBLY



PLANT INFRASTRUCTURE SURFACE TREATMENT



NEXT PAGE

KK LIGHTING INDIA PVT. LTD.

PLANT INFRASTRUCTURE MOULDING



PLANT INFRASTRUCTURE LAB

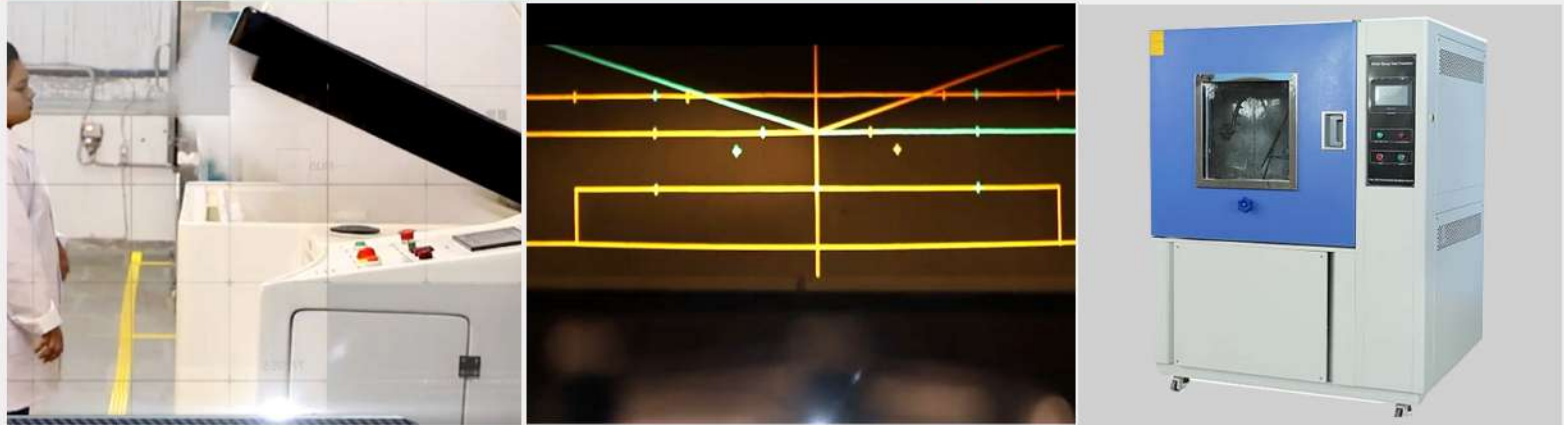

HOT PLATE WELDING MACHINE



LAST PAGE

KK LIGHTING INDIA PVT. LTD.



KK LIGHTING INDIA PRIVATE LIMITED

Plot No. 88, 89 & 71 Phase V, Sector-53, Industrial Estate
Kundali, Sonipat, Haryana-131028 (India)

dheeraj@kklights.com, dheeraj@krisstallight.com

+91-9899106090, +91-9711002299

hitesh@kklights.com, hitesh@krisstallight.com

+91-9871106090, +91-9911002299

www.kklights.com, www.krisstallight.com